

Dimension of one Cell

A.) Manufacturing of the Module Parts

1. Step: Basic Cutting

Tools needed:

- tin snip or angle grinder
- galvanized steel sheet: 0.7 – 0.8 mm thickness
→ 2 pieces of 4 x 8 feet for 12 modules

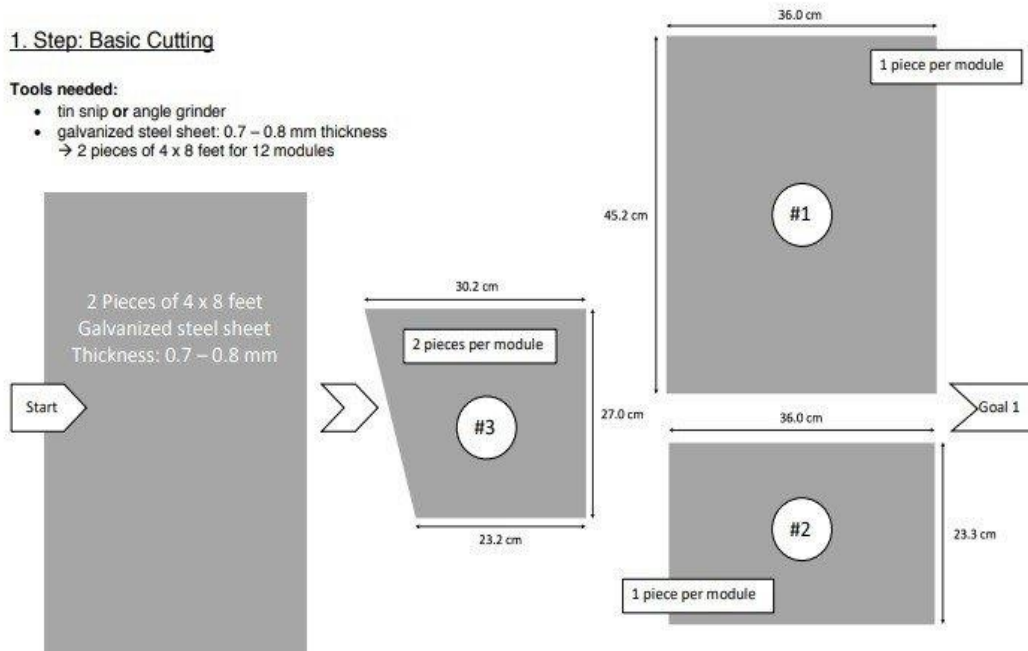

2. Step: Punch marking

Tools needed:

- hammer
- centre punch

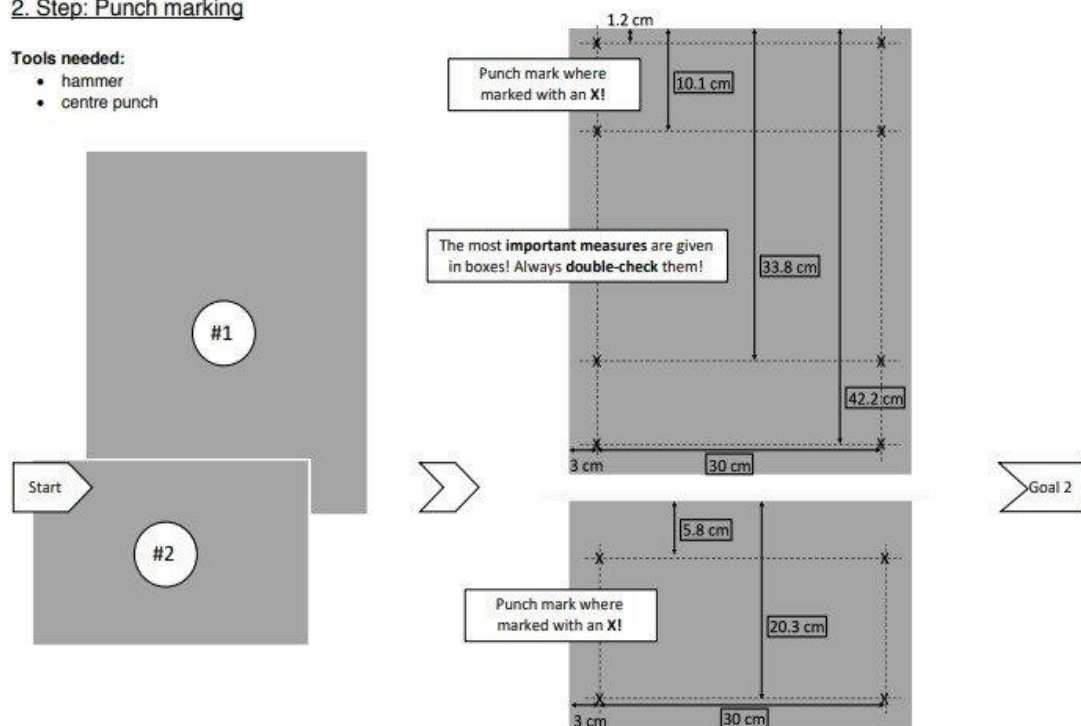

3. Step: Drilling of 9 mm holes

- Tools needed:**
- drill machine
 - 9 mm drill bit

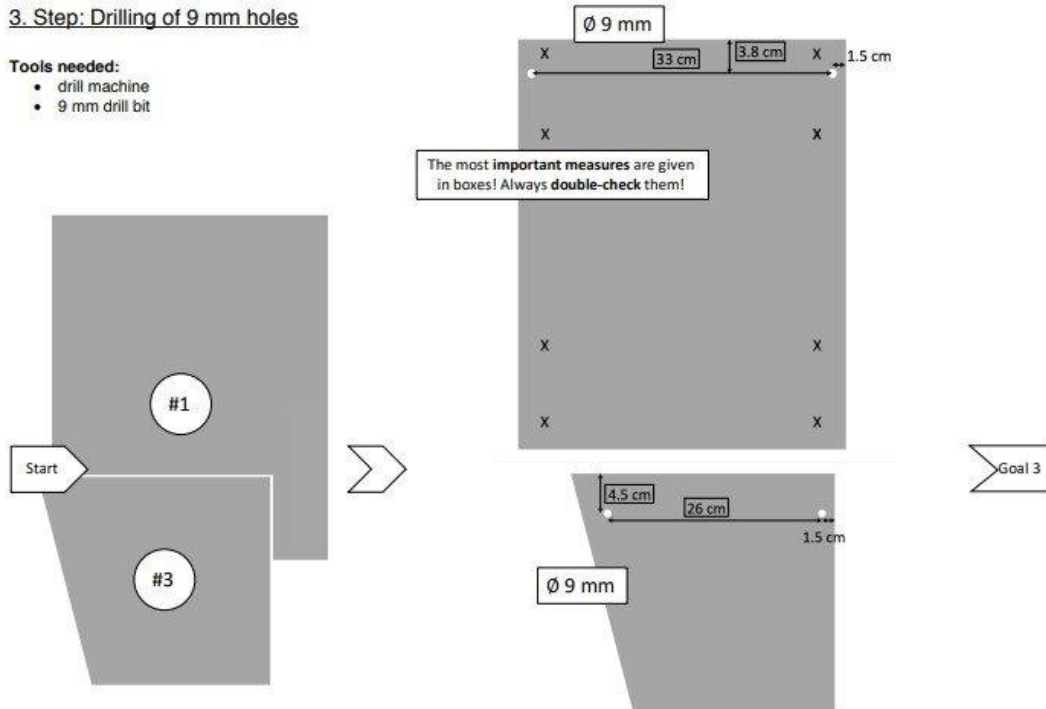

4. Step: Fine Cutting of #1 & #2

- Tools needed:**
- tin snip

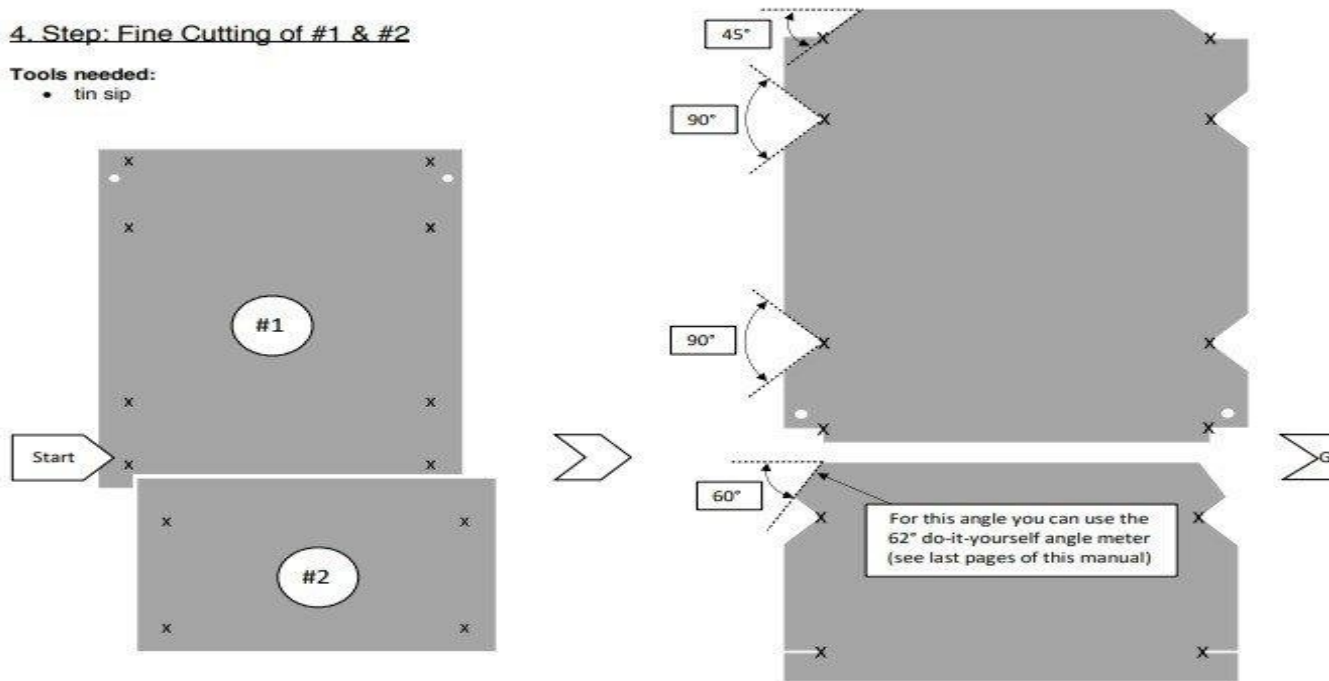

5. Step: Bending of #1

Tools needed:

- bending bench
- hammer
- angle meter

Look at the last pages of this manual for a do-it-yourself angle meter!

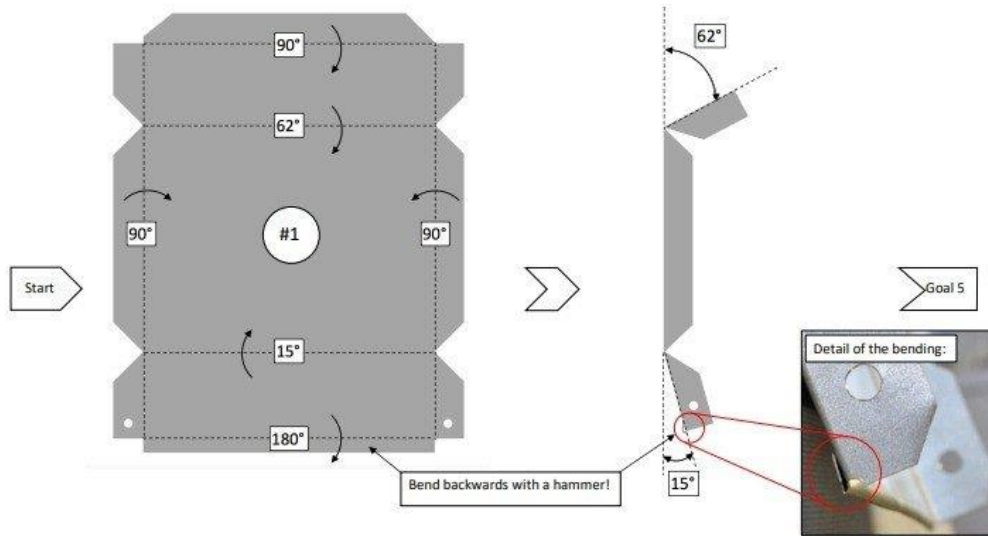

6. Step: Bending of #2

Tools needed:

- bending bench
- angle meter

Look at the last pages of this manual for a do-it-yourself angle meter!

